

Multi-grip, high strength steel and stainless steel break-stem fasteners.



Key features and benefits

- High shear and tensile strength provides strong, vibration resistant joints
- Stainless steel option provides high corrosion resistance and is ideal for applications requiring elevated temperatures
- Multi-grip capability accommodates wide variations in material thickness
- One fastener can be used to replace several standard grip fasteners thus reduced fastener inventory and simpler stock control
- Good hole fill compensates for irregular, oversized, slotted or misaligned holes and can stop movement in non-standard holes
- Retained stem avoids damage, electrical problems or rattling caused by loose stems
- Provides a large blind side bearing area against the rear sheet
- Spreads the tail bearing load/clamp load on the rear sheet making it ideal for use in thin sheet materials

Specifications

Sizes:

1/8" – 1/4"

(3.2 mm – 6.4 mm)

Materials:

Steel, Stainless Steel

Head Styles:

Dome, Large Flange, Countersunk

Typical placing sequence

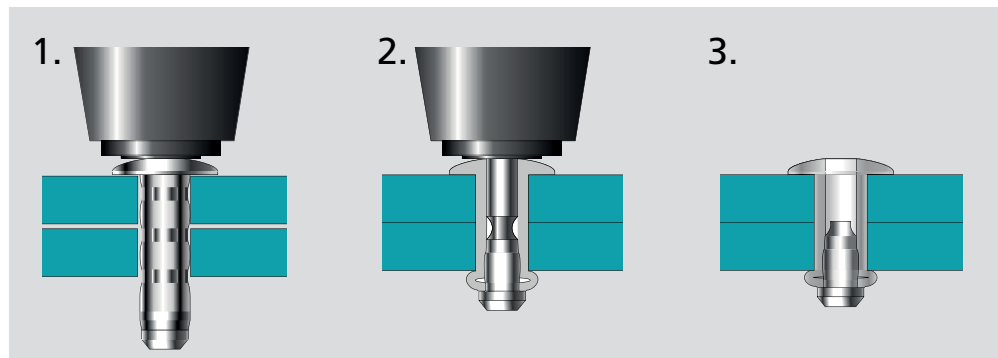

Please visit our website for fastener placing animations and technical data.

Assembly applications

- Automotive
- Commercial vehicles
- Domestic appliances
- Electronics
- Electrical equipment
- General light industrial
- Heating and ventilation

Snowmobile



Passenger air bag



Roll-up security door





English	Français	Deutsch	Italiano	Español
Dome head	Tête plate	Flachrundkopf	Testa tonda	Cabeza alomada
Body: Low carbon steel*	Corps: Acier bas carbone*	Hülse: Stahl*	Corpo: Acciaio a basso tenore di carbonio*	Cuerpo: Acero bajo en carbono*
Zinc plated	Revêtement zingué	Verzinkt	Zincato	Zincado
Stem: Low carbon steel**	Tige: Acier bas carbone**	Dorn: Stahl**	Gambo: Acciaio a basso tenore di carbonio**	Vástago: Acero bajo en carbono**
Zinc plated	Revêtement zingué	Verzinkt	Zincato	Zincado

*: BS3111 Type 0, SAE 1008, DIN 1654, QSt 34-3

** : BS3111 Type 0, SAE 1010/1015/1018/1022, DIN 17210, Cq10 / DIN 1654 Cq10/Cq15/Cq22

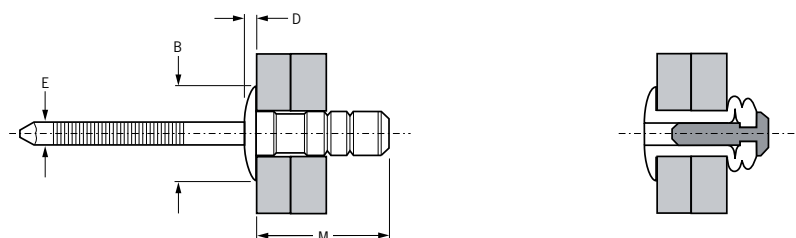

Ø					M	ØB	D	ØE			Part No.
nom.	min.	max.	min.	max.	max.	max.	max.	max.	lbf (kN) min.	lbf (kN) min.	
1/8" (3.2)	.039 (1.0)	.236 (6.0)	.129 (3.3)	.134 (3.4)	.570 (14.5)	.287 (7.3)	.037 (1.0)	.087 (2.2)	202 (0.90)	263 (1.17)	0BS01-00414
5/32" (4.0)	.079 (2.0)	.315 (8.0)	.161 (4.1)	.166 (4.2)	.630 (16.0)	.322 (8.2)	.052 (1.4)	.112 (2.9)	344 (1.53)	405 (1.80)	0BS01-00516
3/16" (4.8)	.060 (1.5)	.200 (5.1)	.192 (4.9)	.196 (5.0)	.480 (12.2)	.397 (10.1)	.061 (1.6)	.120 (3.1)	585 (2.60)	647 (2.88)	0BS01-00612
	.060 (1.5)	.250 (6.3)			.540 (13.8)						0BS01-00614
	.059 (1.5)	.354 (9.0)			.670 (17.1)						0BS01-00618
	.250 (6.3)	.500 (12.7)			.790 (20.1)						0BS01-00622
1/4" (6.4)	.060 (1.5)	.300 (7.6)	.261 (6.6)	.275 (6.9)	.660 (16.8)	.530 (13.5)	.105 (2.7)	.158 (4.0)	700 (3.11)	800 (3.56)	01610-04844 ¹⁾

dimensions in inches and (mm) / en pouces et (millimètre) / alle Maße in Zoll und (mm) / in pollici e (millimetri) / en pulgadas y (milímetros)

1) zinc plated, clear trivalent passivated / revêtement zingué, passivation claire trivalente / verzinkt, klar chromatiert Cr6-frei /
zincato, passivazione chiara trivalente / zincado, pasivado claro trivalente